

NINJA® Foodi®

POWER NUTRI
BLENDER
4-IN-1 WITH
FOOD PREP

CB400UK

INSTRUCTIONS



THANK YOU

for purchasing the Ninja® Foodi® Power Nutri Blender 4-in-1



REGISTER YOUR PURCHASE

 ninjakitchen.co.uk/register-guarantee

 Scan QR code using mobile device

RECORD THIS INFORMATION

Model Number: _____

Serial Number: _____

Date of Purchase: _____
(Keep receipt)

Store of Purchase: _____

TECHNICAL SPECIFICATIONS

Voltage: 220-240V~, 50-60Hz

Power: 1200 Watts

PLEASE READ CAREFULLY AND KEEP FOR FUTURE REFERENCE.

TIP: You can find the model and serial numbers on the QR code label on the back of the unit by the power cord.

PRODUCT REGISTRATION

Please visit registeryourninja.co.uk or call 0800 862 0453 to register your new Ninja® product within 28 days of purchase. You will be asked to provide the store name, date of purchase, and model number along with your name and address.



The registration will enable us to contact you in the unlikely event of a product safety notification.

CONTENTS

Important Safety Instructions.....	4
Parts.....	8
Before First Use.....	9
Getting to know the XL Power Nutri Bowl.....	9
Getting to Know the Disc Assembly.....	9
Using the 2-Part Pusher.....	9
Using the Control Panel.....	10
Using the Total Speed Control.....	10
Using the Auto-iQ Programs.....	11
Using the Jug with Feed Chute Lid & Disc Assembly.....	12
Using the Jug with Flat Lid & Stacked Blade Assembly.....	14
Using the Jug & Dough Blade Assembly.....	16
Using the XL Power Nutri Bowl.....	18
Using the Power Nutri Cup.....	20
Care & Maintenance.....	22
Cleaning Stuck-On Ingredients.....	22
Cleaning.....	23
Storing.....	23
Accessory Storage.....	23
Resetting the Motor.....	23
Ordering Replacement Parts.....	23
Troubleshooting Guide.....	24

IMPORTANT SAFETY INSTRUCTIONS

PLEASE READ CAREFULLY BEFORE USE • FOR HOUSEHOLD USE ONLY

	Read and review instructions for operation and use.
	Indicates the presence of a hazard that can cause personal injury, death or substantial property damage if the warning included with this symbol is ignored.
	For indoor and household use only.
When using electrical appliances, basic safety precautions should always be followed, including the following:	

⚠ WARNING

To reduce the risk of fire, electric shock, serious injury, death, or damage when using this appliance, follow these basic safety precautions.

General Precautions

- 1 Carefully observe and follow all warnings and instructions. This unit contains electrical connections and moving parts that potentially present risk to the user.
- 2 Take your time and exercise care during unpacking and appliance setup. This appliance contains sharp, loose blades that can cause injury if mishandled.
- 3 Take an inventory of all contents to ensure you have all parts needed to properly and safely operate your appliance.
- 4 This product is provided with a Stacked Blade Assembly. **ALWAYS** exercise care when handling blade assemblies. The blade assemblies are sharp and are **NOT** locked in place in their containers. The blade assemblies are designed to be removable to facilitate cleaning and replacement if needed. **ONLY** grasp the blade assembly by the

top of the shaft. Failure to use care when handling the blade assemblies will result in a risk of laceration.

- 5 **ALWAYS** exercise care when handling the Hybrid Edge Blades Assembly. The blades are sharp. **ONLY** grasp the Hybrid Edge Blades Assembly by the outer perimeter of the blade assembly base. Failure to use care when handling the blade assembly will result in a risk of laceration.
- 6 Turn the appliance **OFF**, then unplug the appliance from the socket when not in use, before assembling or disassembling parts and before cleaning. To unplug, grasp the plug by the body and pull from the socket. **NEVER** unplug by grasping and pulling the flexible cord.
- 7 Before use, wash all parts that may come into contact with food. Follow washing instructions covered in this instruction manual.
- 8 Before each use, inspect blade assemblies for damage. If a blade is bent or damage is suspected, contact SharkNinja to arrange for replacement.

- 9 **DO NOT** use this appliance outdoors. It is designed for indoor household use only.
- 10 **DO NOT** operate any appliance with a damaged cord or plug or after the appliance malfunctions or is dropped or damaged in any manner. This appliance has no user-serviceable parts.
- 11 This appliance has important markings on the plug blade. The attachment plug or entire cordset (if plug is moulded on to cord) is not suitable for replacement. If damaged, the appliance shall be replaced.
- 12 Extension cords should **NOT** be used with this appliance.
- 13 To protect against the risk of electric shock, **DO NOT** submerge the appliance or allow the power cord to contact any form of liquid.
- 14 **DO NOT** allow the unit or the cord to hang over the edges of tables or worktop. The cord may become snagged and pull the appliance off the work surface.
- 15 **DO NOT** allow the unit or the cord to contact hot surfaces, including hobs and other heating appliances.
- 16 **ALWAYS** use the appliance on a dry and level surface.
- 17 This appliance must not be used by children. Keep the appliance and its cord out of reach of children.
- 18 This appliance is **NOT** intended to be used by people with reduced physical, sensory, or mental capabilities, or lack of experience and knowledge, unless they have been given supervision or instruction concerning use of the appliance by a person responsible for their safety.
- 19 **ONLY** use attachments and accessories that are provided with the product or are recommended by SharkNinja. The use of attachments not recommended or sold by SharkNinja may cause fire, electric shock, or injury.
- 20 **NEVER** place a blade assembly on the motor base without it first being attached to its corresponding container (jug, cup or bowl) with the lid also in place.
- 21 Keep hands, hair and clothing out of the container when loading and operating.
- 22 During operation and handling of the appliance, avoid contact with moving parts.
- 23 **DO NOT** fill containers past the **MAX FILL** or **MAX LIQUID** lines.

SAVE THESE INSTRUCTIONS

IMPORTANT SAFETY INSTRUCTIONS

PLEASE READ CAREFULLY BEFORE USE • FOR HOUSEHOLD USE ONLY

⚠ WARNING

- 24 DO NOT** operate the appliance with an empty container.
- 25 DO NOT** microwave any containers or accessories provided with the appliance.
- 26 NEVER** leave the appliance unattended while in use.
- 27 DO NOT** blend hot liquids. Doing so may result in pressure buildup and steam exposure that can pose a risk of the user being burned.
- 28 DO NOT** process dry ingredients without adding liquid to the Power Nutri Cup, XL Power Nutri Bowl or jug. They are not intended for dry blending.
- 29 DO NOT** use for grinding ingredients.
- 30 NEVER** operate the appliance without lids and caps in place. **DO NOT** attempt to defeat the interlock mechanism. Ensure the container and lid are properly installed before operation.
- 31** Before operation, ensure all utensils are removed from containers. Failure to remove utensils can cause containers to shatter and potentially result in personal injury and property damage.
- 32** Keep hands and utensils out of containers while chopping to reduce the risk of severe personal injury or damage to the blender/food chopper. A scraper may be used **ONLY** when the blender or processor is not running.
- 33** If you find unmixed ingredients sticking to the sides of the cup, stop the appliance, remove the blade assembly and use a scraper to dislodge ingredients.
- 34 DO NOT** open the jug's pour spout cap while blender is operating.
- 35** If you find unmixed ingredients sticking to the sides of the jug, stop the appliance, remove the lid and use a spatula to dislodge ingredients. **NEVER** insert your hands into the jug, as you may contact one of the blades and experience a laceration.
- 36 DO NOT** attempt to remove the container or lids from the motor base while the blade assembly is still spinning. Allow the appliance to come to a complete stop before removing lids and containers.
- 37** If the appliance overheats, a thermal switch will activate and temporarily disable the motor. To reset, unplug the appliance and allow it to cool for approximately 15 minutes before using again.
- 38 DO NOT** expose the containers and accessories to extreme temperature changes. They may experience damage.
- 39** Upon completion of processing, ensure the blade assembly is removed **BEFORE** emptying container's contents. Remove the blade assembly by carefully grasping the top of the shaft and lifting it from the container. Failure to remove the blade assembly before emptying the container may result in a risk of laceration.
- 40** If using the jug's pour spout, hold the cover in place on the container or ensure lid lock is engaged when pouring to avoid risk of injury.
- 41** Remove the Hybrid Edge Blades Assembly from the Power Nutri Cup or or XL Power Nutri Bowl upon completion of blending. **DO NOT** store ingredients before or after blending them in the cup or bowl with the blade assembly attached. Some foods may contain active ingredients or release gases that will expand if left in a sealed container, resulting in excessive pressure buildup that can pose a risk of injury. For ingredient storage in the cup, use only Spout Lid or Storage Lid to cover. For ingredient storage in the bowl, use only Spout Lid or Storage Lid.

- 42** The maximum wattage rating for this appliance is based on the configuration of the Hybrid Edge Blades Assembly and Power Nutri Cup. Other configurations may draw less power or current.
- 43 DO NOT** submerge the motor base or control panel in water or other liquids.
- 44 DO NOT** spray motor base or control panel with any liquid.
- 45 DO NOT** attempt to sharpen blades.
- 46** Turn off the appliance and unplug the motor base before cleaning.
- 47** Never feed food by hand. Always use food pusher within the feed chute.
- 48** To avoid potential injury, do not misuse the appliance.
- 49** Take care when handling the sharp cutting blades, emptying the bowl and during cleaning.

NOTE: When using the jug and stacked blade assembly, **DO NOT** process more than 600g of raw meat, 600g of Parmesan (hard) cheese, or 700g of cooking chocolate.

SAVE THESE INSTRUCTIONS

PARTS

There are a variety of accessories that are compatible with this blender series.

NOTE: The top flap of your box shows the select accessories that are included with your model.

To purchase more accessories, visit ninjakitchen.co.uk.

PARTS

- A** Flat Lid
- B** 2.1L Power Nutri Jug*
- C** Motor Base
- D** 2-Part Pusher
- E** Feed Chute Lid
- F** Disc Spindle
- G** Total Crushing & Chopping Blade Assembly (Stacked Blade Assembly)
- H** Dough Blade Assembly
- I** Hybrid Edge Blade Assembly
- J** Slicing/Grating Disc
- K** Spout Lid
- L** 700ml Power Nutri Cup**
- M** Storage Lid
- N** 530ml XL Power Nutri Bowl with built in Paddle
- O** Cleaning Brush

*1.8L max liquid capacity.
**650ml max liquid capacity.

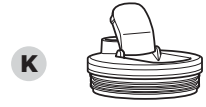
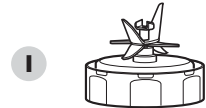
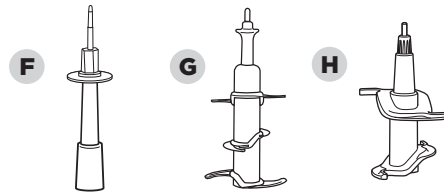
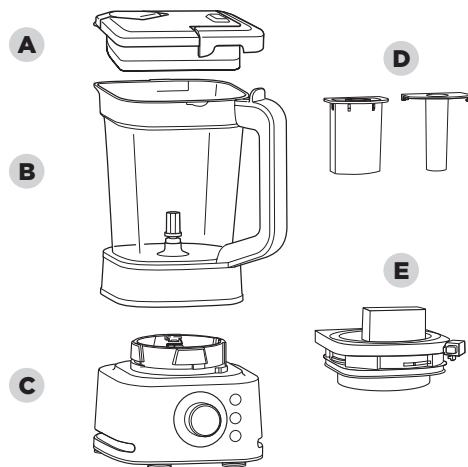

NOTE: The Hybrid Edge Blades Assembly is not compatible with other Ninja products.

BEFORE FIRST USE

IMPORTANT: Review all warnings on pages 4-7 before proceeding.

DID YOU KNOW?

- You can take your drinks on the go using the spout lid.

NOTE: Handle the Hybrid Edge Blades Assembly by grasping around the perimeter of the blade assembly base.

NOTE: All attachments are BPA free and dishwasher safe. It is recommended that the containers, lids and blade assembly be placed on the top rack of the dishwasher. Ensure blade assemblies and lids are removed from the containers before placing in the dishwasher. Exercise care when handling blade assemblies.

- 1 Remove and discard any packaging material and tape from the unit. Some stickers are to be permanently kept on the unit, **ONLY** remove stickers with 'peel here'. Exercise care when unpacking blade assemblies, as the blades are sharp.
- 2 The Stacked Blade Assembly is **NOT** locked in place in the jug. Handle the Stacked Blade Assembly and Dough Blade Assembly by grasping the top of the shaft.
- 3 Handle the Hybrid Edge Blades Assembly by grasping around the perimeter of the blade assembly base.
- 4 Wash containers, lids, blade assemblies and disc in warm, soapy, water using a dishwashing utensil with a handle to avoid direct contact with the blades. Exercise care when handling blade assemblies, as the blades are sharp.
- 5 Thoroughly rinse and air-dry all parts.

NOTE: Place the motor base on a smooth, clean and level surface. **DO NOT** place motor base on a rough or unlevel surface as the suction cup feet will not adhere properly.

GETTING TO KNOW THE XL POWER NUTRI BOWL

Powering through tough and frozen ingredients used to require a lot of stopping, scraping and recipe tinkering. But now, it's easier than ever to create thick and spoonable smoothie bowls, nut butters and more.

All you have to do is twist the Power Paddle while blending to push ingredients down towards the blade.

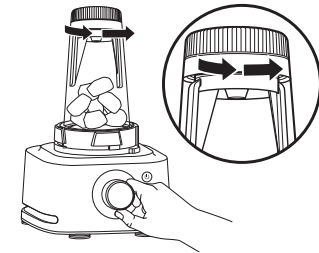

GETTING TO KNOW THE DISC ASSEMBLY

The reversible slicing/grating disc is perfect for outputs like thinly sliced cucumbers and grated carrots. Face the side labelled "SLICER" up for slicing and face the side labelled "SHREDDER" up for grating.

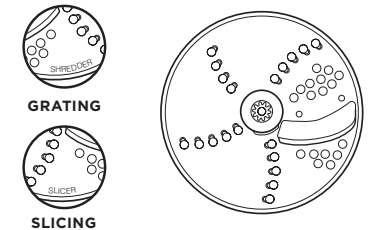

USING THE 2-PART PUSHER

Use the 2-part food pusher to help guide the food through the feed chute. The middle piece of the food pusher is removable to use for narrow ingredients, such as carrots. Rotate the top clockwise and lift to separate the pieces.



USING THE CONTROL PANEL

Use the Power button to turn the unit on or off.

SWITCHING BETWEEN AUTO-iQ AND MANUAL MODE:

To toggle between Auto-iQ Mode and Manual Mode, press the iQ/MANUAL button.

NOTE: In Manual Mode, Auto-iQ programs will not illuminate on the control panel.

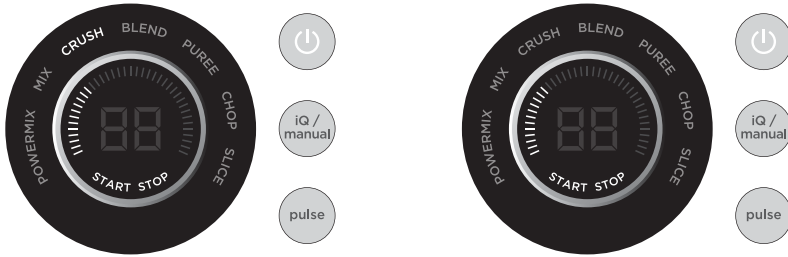

AUTO-iQ MODE

7 unique timed programs customised to take the guesswork out of making great drinks and meals.

SELECT AND RUN AN AUTO-iQ PROGRAM

Use the dial to select the desired program, then press START/STOP to begin. As the program runs, the timer will countdown. When the countdown ends, blending will stop automatically. To stop blending before the end of the program, press START/STOP again.

MANUAL MODE

Choose from 10 different speeds for total control of your blending. Continuously runs up to 60 seconds. Press START/STOP at any time to end program sooner. For best results, use only speed 1 when using the dough blade. Only speed 1 is available when using the feed chute lid and disc assemblies. Only speed 10 is available when using the XL Power Nutri Bowl and Power Nutri Cup.

SELECT AND RUN A MANUAL PROGRAM

Turn the dial from speed 1 to speed 10. Press START/STOP to begin and end blending.

PULSE

Offers greater control of pulsing and blending. Operates only when PULSE is pressed. Use short presses for short pulses and long presses for long pulses.

USING TOTAL SPEED CONTROL & THE JUG

NOTE: If using the Dough Blade Assembly, only use the flat lid and speed 1.

START SLOW

Always start at a low speed (1-3) to better incorporate ingredients and prevent them from sticking to the side of the vessel.

DIAL UP THE SPEED

Smoother blends call for higher speeds. Low speeds are great for chopping vegetables and mixing dough, but you'll need to ramp up for purees and dressings.

HIGH-SPEED BLENDING

Blend until you get your desired consistency. The longer you blend, the better the breakdown and smoother the outcome will be.

USING THE AUTO-iQ PROGRAMS

AUTO-iQ PROGRAMS

Intelligent preset programs combine unique blending and pausing patterns that do the work for you. Once a preset program is selected, it will start immediately and automatically stop when blending is complete. To stop blending before the end of the program, press START/STOP.

NOTE: The unit can detect if the jug or the cup/bowl is installed on the motor base. Only the programs available for a particular container will illuminate on the control panel.

AUTO-iQ PROGRAMS FOR THE POWER NUTRI JUG WITH FLAT LID

BLEND

Combine your favourite fresh or frozen ingredients to make smoothies, milkshakes or protein shakes to share.

CRUSH

Designed to handle the toughest ingredients like nuts, seeds and even ice to make drinks to share, from super healthy smoothies to cocktails.

MIX

Make thick bases for smoothie bowls or creamy frozen yogurts.

PUREE

Blend anything that requires a smooth texture, from dressings to houmous to sauces.

CHOP

Timed pulses and pauses give you consistent chopping results. Run program once for a large chop, twice for a small chop and three times for a finer chop.

AUTO-iQ PROGRAM FOR THE POWER NUTRI JUG WITH FEED CHUTE LID

SLICE

Slice and grate using a variety of fresh ingredients.

NOTE: When using the feed chute lid and disc assembly, only the Slice Program and Speed 1 are available.

AUTO-iQ PROGRAMS FOR THE POWER NUTRI CUP AND XL POWER NUTRI BOWL

BLEND

Combine your favourite fresh or frozen ingredients to make smoothies, milkshakes or protein shakes.

CRUSH

Designed to handle the toughest ingredients like nuts, seeds and even ice to make drinks, from super healthy smoothies to cocktails.

NOTE: For best results when using the Power Nutri Cup, use the Auto-iQ Programs, BLEND & CRUSH.

POWERMIX

Create anything from spreadable peanut butter to the perfect houmous or even pâtés.

MIX

Make thick bases for smoothie bowls or creamy frozen yogurts.

NOTE: For best results when using the XL Power Nutri Bowl, use the Auto-iQ Programs, MIX & POWERMIX.

USING THE JUG WITH FEED CHUTE LID AND DISC ASSEMBLY

IMPORTANT: Review all warnings on pages 4-7 before proceeding.

IMPORTANT: As a safety feature, when the unit is powered on, if the jug and lid are not properly installed, the timer will display “- -” and the motor will be disabled. If this happens, repeat step 4 on this page. When the jug and lid are properly installed, and the unit is powered on, the available programs will illuminate, indicating the appliance is ready to use.

NOTE: The slicing/grating disc is reversible. Use the side labelled “SLICER” for slicing. Carefully flip the disc over to the side labelled “SHREDDER” for grating.

NOTE: The feed chute lid features a 2-part pusher to guide food through the chute. Rotate the top clockwise and lift to separate the pieces.

- 1 Place motor base on a clean, dry, level surface such as a worktop or table, then plug in the unit.

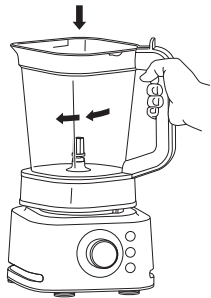

- 2 Lower the jug onto the motor base. The handle should be aligned slightly to the right and the jug should be oriented so the **LOCK** symbols are visible on the motor base. Rotate the jug clockwise until it clicks into place.

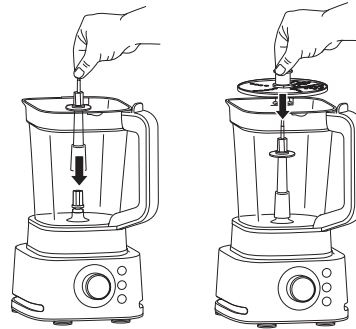

- 3 Place the disc spindle onto the drive gear inside the jug. Then, use the plastic grip to grasp the disc and place it over the spindle.

NOTE: The slicing/grating disc is reversible. Ensure you place the side you would like to use facing up.

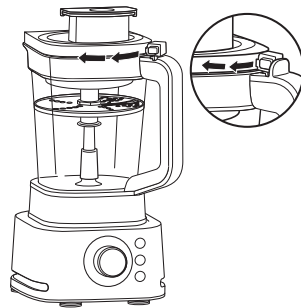

- 4 To install the feed chute lid on the jug, place the lid tab to the right of the handle. Press the lid down until it is secure. Rotate the tab clockwise until it clicks into place on the jug handle. Once the lid is locked in place, press the Power button to turn unit on.

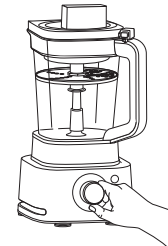

- 5a To use the SLICE Auto-iQ program, press START/STOP.

- 5b For Manual mode, press iQ/MANUAL. With speed 1 on the display, press START/STOP.

NOTE: Only speed 1 is available when using the feed chute lid and disc assembly.

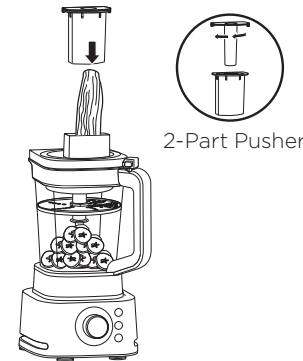

2-Part Pusher

- 6 Add the prepped ingredients you want to slice or grate through the feed chute on the lid. Use the 2-part food pusher to help guide the food through the feed chute. The middle piece of the food pusher is removable to use for narrow ingredients.

NOTE: DO NOT force ingredients through the feed chute. Trim ingredients so that they fit in the chute.

- 7a If using the SLICE program, this preset feature will automatically stop at the end of the program.

- 7b If using Manual mode, press START/STOP when processing is complete. Wait for the unit to come to a complete stop.

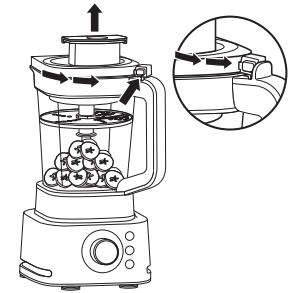

- 8 To remove the lid from the jug, press the release button above the jug handle, and rotate the lid tab anti-clockwise out of the lock position, then lift the entire lid up.

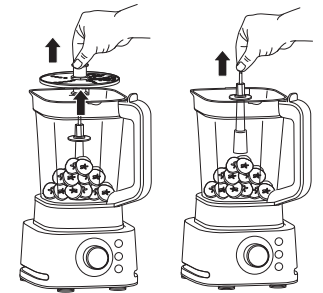

- 9 Using the plastic grip, carefully lift the disc out of the jug. Then, grasp the spindle by the top of the shaft and lift it out of the jug.

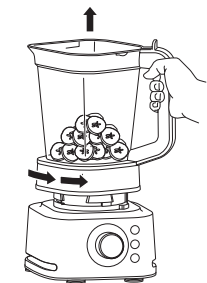

- 10 Remove the jug from the motor base by turning it anti-clockwise and then lifting up.

- 11 Turn the unit off by pressing the Power button. Unplug the unit when finished. Refer to the Care & Maintenance section for cleaning and storage instructions.

USING THE JUG WITH FLAT LID AND STACKED BLADE ASSEMBLY

IMPORTANT: Review all warnings on pages 4-7 before proceeding.

IMPORTANT: As a safety feature, when the unit is powered on, if the jug and lid are not properly installed, the timer will display “-” and the motor will be disabled. If this happens, repeat step 5 on this page. When the jug and lid are properly installed and the unit is powered on, the program button LEDs will illuminate, indicating the appliance is ready to use.

NOTE: Auto-iQ programs have pauses and changes in speed throughout the cycle.

NOTE: DO NOT add ingredients before completing installation of the Stacked Blade Assembly.

NOTE: If the Stacked Blade Assembly is not fully seated, you will not be able to install and lock the lid.

NOTE: The flat lid handle will not fold down unless it is attached to the jug.

- 1 Plug in motor base and place on a clean, dry, smooth, level surface such as a worktop or table.

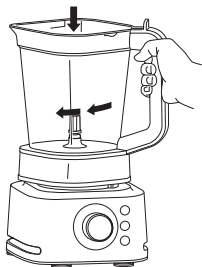

- 2 Lower the jug onto the motor base. The handle should be aligned slightly to the right and the jug should be oriented so the **LOCK** symbols are visible on the motor base. Rotate the jug clockwise until it clicks into place.

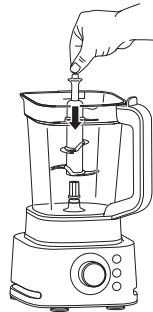

- 3 Exercising care, grasp the Stacked Blade Assembly by the top of the shaft and place it onto the drive gear inside the jug. Note that the blade assembly will fit loosely onto the drive gear.
- 4 Add ingredients to the jug. **DO NOT** add ingredients past the **MAX LIQUID** line on the jug.

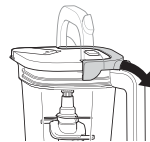

- 5 Place the lid on the jug. Press down on the handle until it clicks into place. Once the lid is locked in place, press the Power button to turn unit on. The available program buttons will illuminate and the unit will be ready for use.

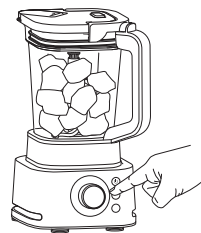

- 6a If using an Auto-iQ program, use the dial to select the program that best suits your desired output, then press START/STOP. The preset feature will automatically stop at the end of the program. To stop the unit at any time, press START/STOP.

- 6b For Manual mode, press iQ/MANUAL. Use the dial to select your desired speed, ranging from 1 to 10 and press START/STOP. Once the ingredients have reached your desired consistency, press START/STOP and wait for the unit to come to a complete stop.

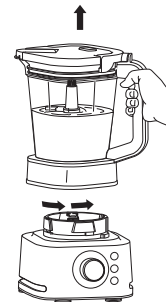

- 7 Remove the jug from the motor base by turning it anti-clockwise and then lifting up.

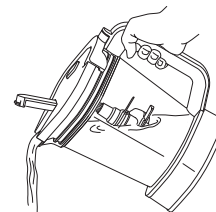

- 8a To pour out thinner mixtures, ensure the lid is locked in place, then open the pour spout cap.

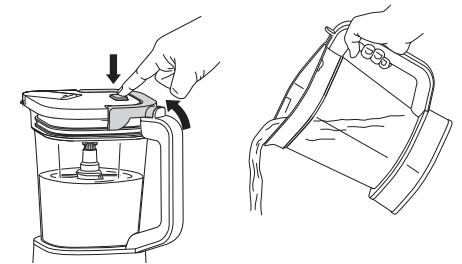

- 8b For thicker mixtures that cannot be emptied through the pour spout, remove the lid and Stacked Blade Assembly before pouring. To remove the lid, press the **RELEASE** button and lift the handle. To remove the blade assembly, carefully grasp it by the top of the shaft and pull straight up. The jug can then be emptied.

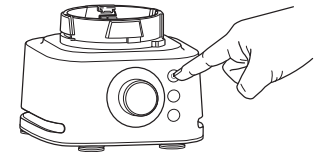

- 9 Turn the unit off by pressing the Power button. Unplug the unit when finished. Refer to the Care & Maintenance section for cleaning and storage instructions.

USING THE JUG & DOUGH BLADE ASSEMBLY

IMPORTANT: Review all warnings on pages 4-7 before proceeding.

IMPORTANT: As a safety feature, when the unit is powered on, if the jug and lid are not properly installed, the timer will display "--" and the motor will be disabled. If this happens, repeat step 5 on this page. When the jug and lid are properly installed and the unit is powered on, the program button LEDs will illuminate, indicating the appliance is ready to use.

NOTE: Auto-iQ programs have pauses and changes in speed throughout the cycle.

NOTE: DO NOT add ingredients before completing installation of the Dough Blade Assembly.

NOTE: If the Dough Blade Assembly is not fully seated, you will not be able to install and lock the lid.

NOTE: The flat lid handle will not fold down unless it is attached to the jug.

- 1 Plug in motor base and place on a clean, dry, smooth, level surface such as a worktop or table.

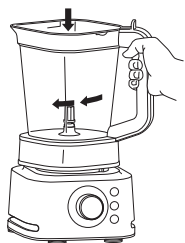

- 2 Lower the jug onto the motor base. The handle should be aligned slightly to the right and the jug should be oriented so the **LOCK** symbols are visible on the motor base. Rotate the jug clockwise until it clicks into place.

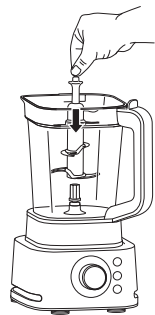

- 3 Exercising care, grasp the Dough Blade Assembly by the top of the shaft and place it onto the drive gear inside the jug. Note that the blade assembly will fit loosely onto the drive gear.



- 4 Add ingredients to the jug. **DO NOT** add ingredients past the **DOUGH MAX** or **COOKIE MAX** line on the jug.



- 5 Place the lid on the jug. Press down on the handle until it clicks into place. Once the lid is locked in place, press the Power button to turn unit on. The available program buttons will illuminate and the unit will be ready for use.



- 6 Press iQ/MANUAL. Use the dial to select speed 1, then press START/STOP. Once the ingredients have reached your desired consistency, press START/STOP and wait for the unit to come to a complete stop.

IMPORTANT: Only use speed 1 when using the Dough Blade Assembly.

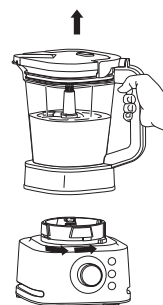

- 7 Remove the jug from the motor base by turning it anti-clockwise and then lifting up.

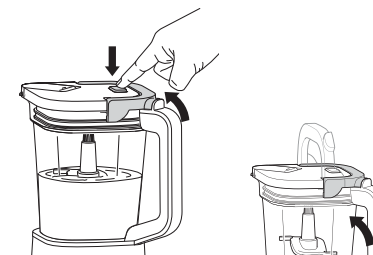

- 8 Remove the lid and Dough Blade Assembly before removing contents. To remove the lid, press the **RELEASE** button and lift the handle. To remove the blade assembly, carefully grasp it by the top of the shaft and pull straight up. The jug can then be emptied.

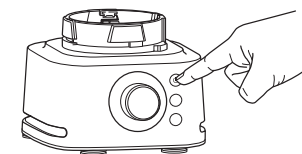

- 9 Turn the unit off by pressing the Power button. Unplug the unit when finished. Refer to the Care & Maintenance section for cleaning and storage instructions.

USING THE XL POWER NUTRI BOWL

IMPORTANT: Review all warnings on pages 4-7 before proceeding.

NOTE: If the unit is plugged in and powered on, but the bowl and blade assembly is not properly installed, the timer will display "--" and the motor will be disabled.

NOTE: Auto-iQ programs have pauses and changes in speed throughout the cycle.

- 1 Plug in motor base and place on a clean, dry, smooth, level surface such as a worktop or table.



- 2 Add ingredients to the Power Nutri Bowl. **DO NOT** add liquid past the **LIQUID FILL** line or ingredients past the **MAX FILL** line.



- 3 Place the Hybrid Edge Blades Assembly on the top of the bowl and turn clockwise to seal.

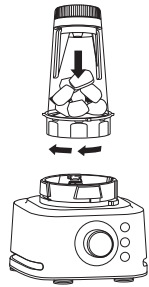

- 4 Turn the XL bowl upside down and install on motor base by aligning the tabs on the bowl with the slots on the base. Then, rotate bowl clockwise until it clicks. Once locked in place, press the Power button to turn unit on. The available program buttons will illuminate and the unit will be ready for use.

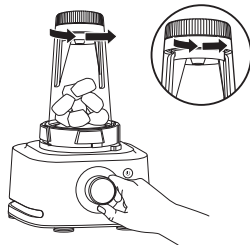

NOTE: While processing, twist the Power Paddle *anti-clockwise* continuously.

- 5a If using an Auto-iQ program, use the dial select the program that best suits your desired output, then press START/STOP. During the blending process, ensure to twist the Power Paddle **anti-clockwise** continuously. The preset feature will automatically stop at the end of the program. To stop the unit at any time, press START/STOP.

- 5b For Manual mode, press iQ/MANUAL. With speed 10 on the display, press START/STOP. During the blending process, twist the Power Paddle **anti-clockwise** continuously. Once the ingredients have reached your desired consistency, press START/STOP and wait for the unit to come to a complete stop.

NOTE: Only speed 10 is available when using the Power Nutri Bowl.

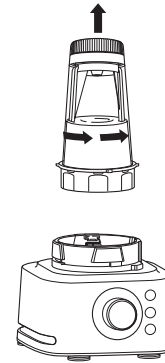

- 6 Remove the bowl from the motor base by turning it anti-clockwise and then lifting up.



- 7 Remove the blade assembly by twisting anti-clockwise. **DO NOT** store blended contents with the blade assembly attached. Only use the Spout Lid or Storage Lid to cover. Exercise care when handling the blade assembly, as the blades are sharp.



- 8 To enjoy on the go, place the Spout Lid or Storage Lid onto the bowl and twist clockwise until firmly sealed.

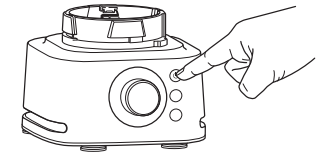

- 9 Turn the unit off by pressing the Power button. Unplug the unit when finished. Refer to the Care & Maintenance section for cleaning and storage instructions.

USING THE POWER NUTRI CUP

IMPORTANT: Review all warnings on pages 4-7 before proceeding.

NOTE: If the unit is plugged in and powered on, but the cup and blade assembly is not properly installed, the timer will display “- -” and the motor will be disabled.

NOTE: Auto-iQ programs have pauses and changes in speed throughout the cycle.

- 1 Plug in motor base and place on a clean, dry, smooth, level surface such as a worktop or table.



- 2 Add ingredients to the Power Nutri Cup. **DO NOT** add ingredients past the **MAX LIQUID** line.



- 3 Place the Hybrid Edge Blades Assembly on the top of the cup and turn clockwise to seal.

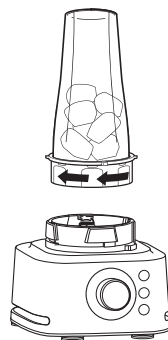

- 4 Turn the cup upside down and install on the motor base by aligning the tab on the cup with the slots on the base. Then, rotate cup clockwise until it clicks. Once locked in place, press the Power button to turn unit on. The available program buttons will illuminate and the unit will be ready for use.

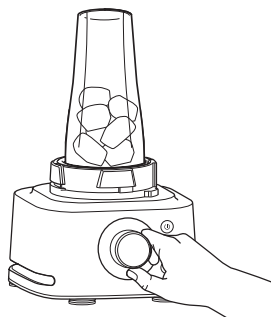

- 5a If using an Auto-iQ program, use the dial to select the program that best suits your desired output, then press START/STOP. The preset feature will automatically stop at the end of the program. To stop the unit at any time, press START/STOP.

- 5b For Manual mode, press iQ/MANUAL. With speed 10 on the display, press START/STOP. Once the ingredients have reached your desired consistency, press START/STOP and wait for the unit to come to a complete stop.

NOTE: Only speed 10 is available when using the Power Nutri Cup.

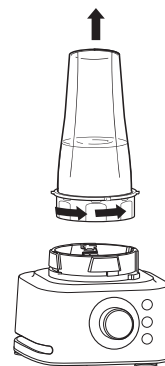

- 6 Remove the cup from the motor base by turning it anti-clockwise and then lifting up.



- 7 Remove the blade assembly by twisting anti-clockwise. **DO NOT** store blended contents with the blade assembly attached. Only use the Spout Lid or Storage Lid to cover. Exercise care when handling the blade assembly, as the blades are sharp.



- 8 To enjoy on the go, place the Spout Lid or Storage Lid onto the cup and twist clockwise until firmly sealed.

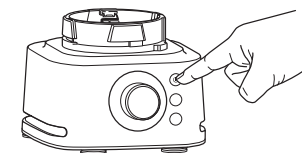

- 9 Turn the unit off by pressing the Power button. Unplug the unit when finished. Refer to the Care & Maintenance section for cleaning and storage instructions.

CARE & MAINTENANCE

CLEANING STUCK-ON INGREDIENTS

- 1 After processing, immediately clean the container and blade assembly under warm, soapy water.
- 2 Depending on the container, fill with washing-up liquid and water according to the following instructions:

Jug:

1 OR 2 SMALL DROPS OF WASHING-UP LIQUID

FILL WATER TO DOUGH MAX LINE

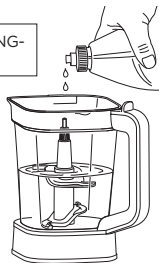

With the dough or stacked blade assembly installed, fill with warm water up to DOUGH MAX line and add 1 or 2 small drops washing-up liquid. Secure flat lid and ensure the pour spout is securely closed.

XL Power Nutri Bowl:

1 OR 2 SMALL DROPS OF WASHING-UP LIQUID

FILL WATER TO TOP OF POWER PADDLE



Fill with warm water up to top of Power Paddle and add 1 or 2 small drops washing-up liquid. Install blade assembly.

Power Nutri Cup:

1 SMALL DROP OF WASHING-UP LIQUID

FILL WATER HALFWAY



Fill halfway with warm water and add 1 small drop washing-up liquid. Install blade assembly.

- 3 Install the container on the motor base. Select MIX, then press START/STOP.

NOTE: If using the **XL Power Nutri Bowl**, twist the Power Paddle anti-clockwise *continuously* while cleaning.



- 4 Once program is complete, thoroughly rinse container and blade assembly under warm, soapy water. Use the included cleaning brush to remove any remaining residue.

CLEANING

Hand-Washing

Wash containers, lids, discs and blade assemblies in warm, soapy water. Use a dishwashing utensil with handle to avoid direct contact with the blades. Use the included cleaning brush to remove excess residue, such as when dealing with stuck-on ingredients, like doughs and batters. Exercise care when handling the blade assembly as the blades are sharp. Thoroughly rinse and air-dry all parts.

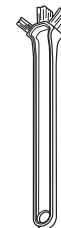

NOTE: The Power Paddle in the XL Power Nutri Bowl is not removable.

Dishwasher

Containers, lids, disc and blade assembly are top-rack dishwasher safe. Ensure the blade assembly and lid are removed from the container before placing in the dishwasher.

NOTE: For best results, use a dishwasher to remove stuck-on ingredients.

Motor Base

Unplug the motor base before cleaning. Wipe motor base with a clean, damp cloth. **DO NOT** use abrasive cloths, pads or brushes to clean the base.

STORING

For cord storage, wrap cord with hook-and-loop fastener near the back of the motor base. **DO NOT** wrap the cord around the bottom of the base for storage.

DO NOT store blended or unblended ingredients in the cup or bowl with the blade assembly attached.

DO NOT stack items on top of the containers. Store any remaining attachments alongside the unit or in a cupboard where they will not be damaged or create a hazard.

ACCESSORY STORAGE

To purchase a storage case to house most attachments that come with this unit, visit ninjakitchen.co.uk. Store the Hybrid Edge Blades Assembly with the Power Nutri Cup and the storage lid with the XL Power Nutri Bowl. For cord storage, wrap cord with hook-and-loop fastener near the back of the motor base.

DO NOT wrap the cord around the bottom of the base for storage.

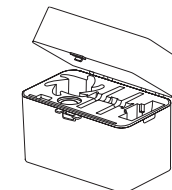

RESETTING THE MOTOR

This unit features a safety system that prevents damage to the motor and drive system should you inadvertently overload it. If the unit is overloaded, the motor will be temporarily disabled. Should this occur, follow the reset procedure below.

- 1 Unplug the unit from the electrical socket.
- 2 Allow the unit to cool for approximately 15 minutes.
- 3 Remove the container's lid and blade assembly. Empty the container and ensure no ingredients are jamming the blade assembly.

IMPORTANT: Ensure that maximum capacities are not exceeded. This is the most typical cause of appliance overload.

ORDERING REPLACEMENT PARTS

To order additional parts and attachments, visit ninjakitchen.co.uk

VISIT US ONLINE AT:

ninjakitchen.co.uk

Or follow us on any of our social media pages:



@ninjakitchenuk

NOTE: Save these instructions. Keep for future reference.



This marking indicates this product should not be disposed of with other household waste. To prevent possible harm to the environment or human health from uncontrolled waste disposal, recycle it responsibly to promote the sustainable reuse of material sources. To return your used device, please use the return and collection systems or contact the retailer where this product was purchased. They can take this product for environmentally safe recycling.

**SharkNinja Europe Limited,
3150 Century Way, Thorpe Park,
Leeds, LS15 8ZB, UK
+44 (0)800 862 0453
www.ninjakitchen.co.uk**

**SharkNinja Germany GmbH,
c/o Regus Management GmbH,
Excellent Business Center 10.+11. Stock,
Westhafenplatz 1,
60327 Frankfurt am Main, Germany
www.ninjakitchen.eu**

Illustrations may differ from actual product. We are constantly striving to improve our products, therefore the specifications contained herein are subject to change without notice.

AUTO-IQ, FOODI, NINJA and TOTAL CRUSHING are registered trademarks in the United Kingdom of SharkNinja Operating LLC.

HYBRID EDGE and POWER NUTRI are unregistered trademarks in the United Kingdom of SharkNinja Operating LLC.

© 2022 SharkNinja Operating LLC

PRINTED IN CHINA

CB400UK_IB_MP_220425_Mv3

