

NINJA®

BL642UK
OWNER'S GUIDE



www.ninjakitchen.eu
0800 862 0453

IMPORTANT SAFETY INSTRUCTIONS

For Household Use Only

WHEN USING ELECTRICAL APPLIANCES, BASIC SAFETY PRECAUTIONS SHOULD ALWAYS BE FOLLOWED, INCLUDING THE FOLLOWING:

READ ALL INSTRUCTIONS BEFORE USING YOUR NUTRI NINJA® I NINJA® BLENDER WITH AUTO-IQ® TECHNOLOGY.

⚠ WARNING: Extension cords are not recommended for use with this product.

⚠ WARNING: The blades are not affixed to the unit. They are removable and very sharp. Handle with care!

⚠ CAUTION: In order to avoid a hazard due to inadvertent resetting of the thermal cut-out, this appliance must not be supplied through an external switching device, such as a timer, or connected to a circuit that is regularly switched on and off by the utility.

IMPORTANT: This appliance is not intended for use by persons with reduced physical, sensory or mental capabilities, or lack of experience and knowledge, unless they have been given supervision or instruction concerning use of the appliance by a person responsible for their safety.

Children shall not use or play with this appliance. Close supervision is necessary to keep appliance and cord out of reach of children during use.

SAVE THESE INSTRUCTIONS

⚠ WARNING: TO REDUCE THE RISK OF FIRE, ELECTRIC SHOCK OR INJURY:

- ⚠ WARNING:** Remove utensils prior to processing. Failure to remove may cause the jar to be damaged or to shatter which may cause personal injury.
- ⚠ WARNING:** The blade assemblies are sharp, not locked in place and removable, handle with care. When handling the blade assemblies, always hold by the shaft. Failure to do so will result in a risk of laceration.
- ⚠ WARNING:** Stacked Blade Assembly is sharp and not locked in place. If using the pour spout, ensure the lid is fully locked onto the pitcher. If pouring with the lid removed, carefully remove the Stacked Blade Assembly first, holding it by the shaft. Failure to do so will result in a risk of laceration.
- ⚠ CAUTION:** Do not blend hot liquids, doing so may cause excessive pressure build-up, resulting in risk of the user being burned.
- ⚠ CAUTION:** We do not recommend grinding in any of our Nutri Ninja® cups.
- ⚠ CAUTION:** Remove the Pro Extractor Blades Assembly from the Nutri Ninja cup upon completion of blending. Do not store ingredients before or after blending them in the cup with the blade assembly attached. Some foods may contain active ingredients or release gases that will expand if left in a sealed container, resulting in excessive pressure buildup that can pose a risk of injury. For ingredient storage in the cup, use only Spout Lid to cover.
- To protect against electrical shock, do not submerge the appliance or allow the power cord to come into contact with water or any other liquid.
- DO NOT allow the appliance to be used by children. Close attention is necessary when used near children. This is not a toy.
- Never leave an appliance unattended when in use.

- Turn the appliance off and remove the power cord from the electrical outlet when not in use, before assembling or disassembling parts, accessing parts that move while in use and before cleaning. To unplug, grasp the plug and pull from the electrical outlet. Never pull from the power cord.
- DO NOT abuse the power cord. Never carry the appliance by the power cord or yank it to disconnect from electrical outlet; instead, grasp the plug and pull to disconnect.
- DO NOT use with damaged supply cord or plug. If the supply cord or plug is damaged, it must be replaced by the manufacturer, a service center or similar qualified persons in order to avoid hazard.
- DO NOT USE if the appliance is not working, has been dropped, dropped into water, damaged or left outdoors.
- NO SERVICEABLE PARTS. Incorrect re-assembly or repair can cause a risk of electrical shock or injury to persons when the appliance is used. Contact Customer Service or a Service Center for the repair or replacement under the warranty agreement.
- Always use the appliance on a dry, level surface.
- Keep hands, hair, clothing, as well as utensils out of container while processing or blending to reduce the risk of severe injury to persons or damage to the appliance. A scraper may be used but only when the appliance is not running.
- Avoid contact with moving parts.
- DO NOT attempt to sharpen blades.
- DO NOT use the appliance if either set of blades are bent or damaged.
- To reduce the risk of injury, never assemble the blade assemblies in the containers without the pitcher or the bowl being properly attached to the motor base.
- DO NOT operate this appliance on or near any hot surfaces (such as gas or electric burner or in a heated oven).
- The use of attachments or accessories including canning jars, not recommended by the manufacturer may result in fire, electric shock or personal injury.
- DO NOT remove any container from the motor base while the appliance is in operation. Always unplug the unit when not in use.
- To reduce risk of injury, never place the blade assemblies on the base without the pitcher or Nutri Ninja® cup properly attached.
- To reduce the risk of injury, NEVER operate the appliance without the lid in place; DO NOT try to defeat or bypass the interlock mechanism. When using the removable blades, make sure they are properly installed before operating the appliance.
- DO NOT expose containers to extreme temperature changes.
- DO NOT let the power cord hang over the edge of table or counter or touch hot surfaces such as the stove.
- DO NOT overfill. DO NOT exceed "MAX" fill line.
- DO NOT operate the appliance empty.
- To reduce the risk of burns, always allow the appliance to cool before taking off parts and before cleaning.
- Max ON time is 60 seconds under 1500W load. If the appliance overheats, a thermal switch will become activated and shut off the motor. To reset, unplug the appliance and let it cool down for approximately 15 minutes before using again.
- In the event that the unit overloads, the control panel lights will flash and the unit will shut down. Unplug the appliance and let it cool down for approximately 15 minutes before using again.
- Max PULSE iteration is 30 Pulses. After 30 Pulses allow 10 minutes to pass before running the PULSE function up to an additional 30 Pulses.
- The maximum rating is based on the Stacked Blade Assembly (pitcher) that drives the greatest power and other recommended attachments may draw significantly less power or current.
- To avoid injury, never attempt to place the Pro Extractor Blade™ onto the motor base without first assembling the blade assembly to the Nutri Ninja Cup.
- DO NOT push food into the food chute with your fingers. Always use the food pusher provided.
- Appliance accessories are not intended to be used in the microwave as it may result in damage to the accessories.
- THIS PRODUCT IS INTENDED FOR HOUSEHOLD USE ONLY. Do not use this appliance for anything other than its intended use. Do not use outdoors.

This appliance complies with the WEEE-Directive 2012/19/EU on the disposal of electrical and electronic equipment (WEEE).



This marking indicates that this product should not be disposed with other household wastes throughout the EU. To prevent possible harm to the environment or human health from uncontrolled waste disposal, recycle it responsibly to promote the sustainable reuse of material sources. To return your used device, please use the return and collection systems or contact the retailer where this product was purchased. They can take this product for environmental safe recycling.

This appliance complies with the European directives for electromagnetic compatibility (EMC) 2014/30/EU and its revisions, as well as Low Voltage Directive (LVD) 2014/35/EU and its revisions.

Guarantee: This product is unconditionally guaranteed for one year against all defects of workmanship and materials. This guarantee does not affect your statutory rights. If this product proves unsatisfactory please contact our customer service department on freephone 0800 862 0453 or by e-mail ukservice@euro-pro.com.

THIS BOOK COVERS MODEL NUMBERS:

BL642UK 30

TECHNICAL SPECIFICATIONS

Voltage: 220-240V~, 50-60Hz.
Power: 1500W
Pitcher Capacity: 2.1L
Max Liquid: 2L
Nutri Ninja®
Cup Capacity: 500ml
650ml
900ml



Contents

Getting to Know Your Nutri Ninja I Ninja Blender with Auto-iQ Technology.....5
Before First Use 7
Assembly and Use for the Ninja Blender 8
Assembly and Use for the Nutri Ninja Cups 10
Programs, Speed Settings, & Uses for the Pitcher 12
Programs, Speed Settings, & Uses for the Nutri Ninja Cups 12
Care & Maintenance 13
Troubleshooting Guide..... 14

Thank you for purchasing The Nutri Ninja® I Ninja® Blender with Auto-iQ® Technology.

Getting To Know Your Nutri Ninja® | Ninja® Blender with Auto-iQ® Technology

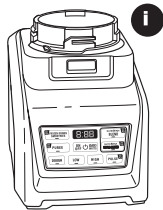
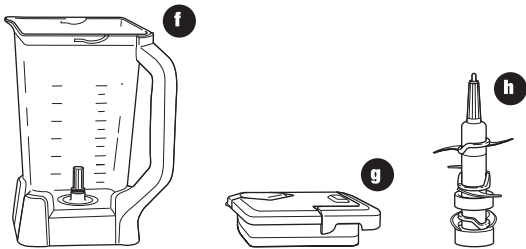
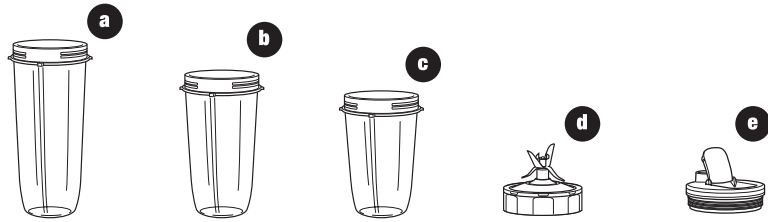

- a 900ml Nutri Ninja Cup
- b 650ml Nutri Ninja Cup
- c 500ml Nutri Ninja Cup
- d Pro Extractor Blades™ Assembly
- e Spout Lid

- f Pitcher
- g Blender Lid with locking handle
- h Stacked Blade Assembly (blender)

- i Motor Base

The Nutri Ninja® | Ninja® Blender with Auto-iQ® Technology is a high powered innovative tool with a sleek design and outstanding performance, a true asset to any kitchen. The Nutri Ninja | Ninja Blender with Auto-iQ Technology features intelligent programs that combine pulsing, blending and pausing patterns that do the work for you! Get great results every time with no guesswork required! For best results, be sure to carefully read all the instructions contained in the manual before using this appliance.

Nutri Ninja | Ninja Blender with Auto-iQ Technology Features:

- Patent Pending Ninja Blade Technology
- BPA Free Pitcher (maximum liquid capacity 2L), Nutri Ninja Cups, and Lids
- Drip-Free Pour Spout
- Total Crushing® Technology
- LED Control Panel with Timer
- Sturdy, Non-Slip Base
- Smart Lid technology for easy release
- 3 speeds: Low/Dough, Medium, & High
- 5 Auto-iQ settings - Auto-iQ Frozen Drinks/Smoothies, Auto-iQ Food Puree, Nutri Ninja Auto-iQ Blend, Nutri Ninja Auto-iQ Ultra Blend and Auto-iQ Pulse
- Nutri Ninja Nutrient & Vitamin Extraction*

*Extract a drink containing vitamins and nutrients from fruits and vegetables.

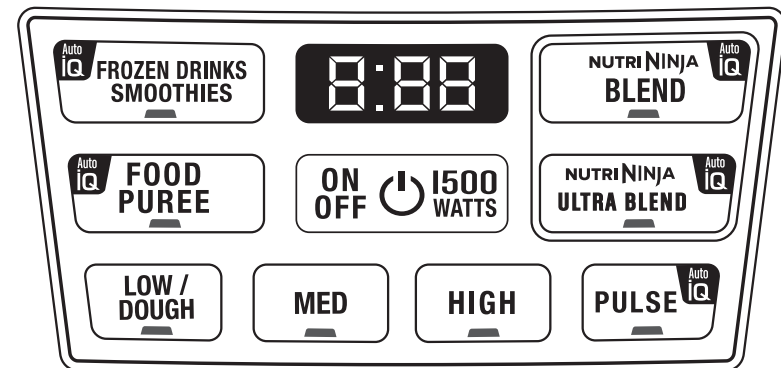

Before First Use

PLEASE KEEP THESE IMPORTANT SAFEGUARDS IN MIND WHEN USING THE APPLIANCE:

IMPORTANT: Make sure that the motor base is plugged in for use.

IMPORTANT: Never add ingredients into the container before placing the attachment in first.

IMPORTANT: Attachments are not interchangeable.

IMPORTANT: DO NOT attempt to operate the appliance without the lid on.

IMPORTANT: Never run the appliance empty.

IMPORTANT: Appliance accessories are not intended to be used in the microwave as it may result in damage to the accessories.

▲ WARNING: Stacked Blade Assembly is sharp and not locked in place. If using the pour spout, ensure the lid is fully locked onto the pitcher. Failure to do so will result in a risk of laceration.

▲ WARNING: Stacked Blade Assembly is sharp and not locked in place. If pouring with the lid removed, carefully remove the Stacked Blade Assembly first, holding it by the shaft. Failure to do so will result in a risk of laceration.

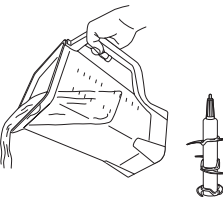
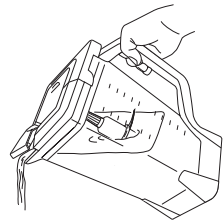

▲ CAUTION: Do not immerse the motor base into water or any other liquid.

- 1 Remove all packaging material and labels from the appliance. Separate/remove all parts from each other.
- 2 Wash the lids, pitcher, Nutri Ninja cups and blade assemblies in warm, soapy water. When washing the blade assemblies, use a dish-washing utensil with a handle to avoid direct hand contact with blades.
- ▲ WARNING:** Handle the Blade Assemblies with care when washing, as the blades are sharp.
- 3 Handle blade assemblies with care to avoid contact with sharp edges. Rinse and air dry thoroughly.
- 4 The pitcher, Nutri Ninja cups, lids, and blade assemblies are all dishwasher safe. It is recommended that the lids and blade assemblies be placed on the top rack. Ensure the blade assemblies are removed from the containers before placing in the dishwasher.
- 5 Wipe the motor base clean with a damp cloth.

Assembly and Use for the Ninja® Blender

- ▲ WARNING:** Handle the Stacked Blade Assembly with care, as the blades are sharp.
 - ▲ WARNING:** Remove utensils prior to processing. Failure to remove may cause the pitcher to be damaged or to shatter, which may cause personal injury.
 - ▲ WARNING:** Never leave the appliance unattended while in use.
 - ▲ CAUTION:** Do not blend hot liquids, doing so may cause excessive pressure buildup, resulting in risk of the user being burned.
- IMPORTANT:** Make sure that the motor base is plugged in for use.

ASSEMBLY

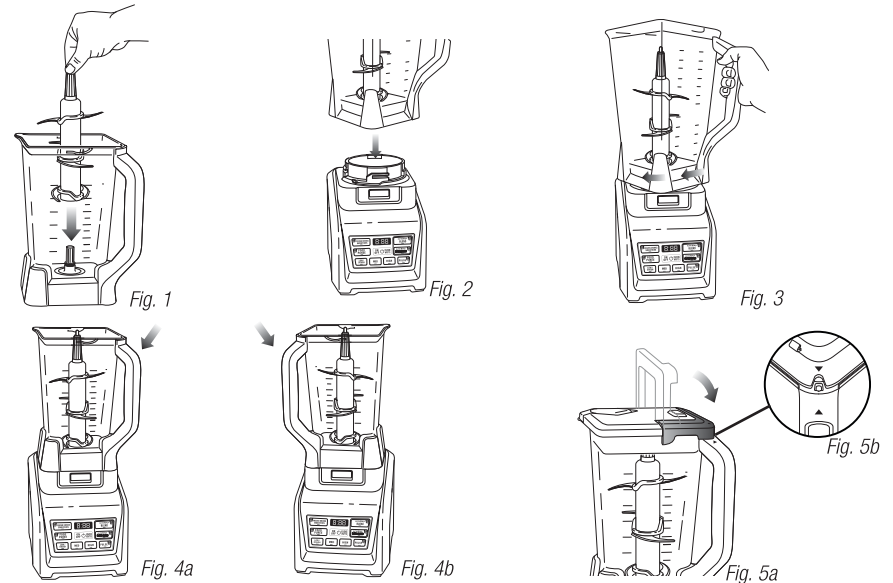

- 1 Review warning and caution statements above before proceeding to number 2.
- 2 Place the motor base on a clean, dry, level surface such as a counter or table top.
- 3 Holding the Stacked Blade Assembly by the top of the shaft, place it onto the drive gear inside the pitcher. Ensure that the Stacked Blade Assembly is seated properly and is standing upright. **(Fig. 1)**
NOTE: The Stacked Blade Assembly will fit loosely on the drive gear.
- 4 Place the motor base on a clean, dry, level surface such as a counter or table top.
- 5 Align and lower the Pitcher onto the motor base. **(Fig. 2)** Handle should be aligned slightly to the right of the "LOCK" symbol on the motor base.
- 6 Rotate the pitcher clockwise until it locks in place, you will hear a click when the lock is engaged. **(Fig. 3)**
- 7 The pitcher can be placed on the motor base two ways; the handle can be on the front right corner or the front left corner. **(Fig. 4a, Fig. 4b)**
- 8 Add the ingredients to the pitcher, making sure that they do not exceed the highest measured marking line on the side of the pitcher.
NOTE: When blending any kind of liquids, such as mixtures of any drinks or smoothies, do not exceed the "MAX LIQUID" mark (2 L) on the pitcher.
NOTE: If you need to add additional ingredients while the appliance is processing, open the pour spout cap and pour the ingredients in through the opening.
- 9 Holding the lid by the handle in the upright position, place it on top of the pitcher aligning the triangle (▼) located on the lid with the triangle (▲) located on the pitcher's handle. **(Fig. 5a)** Press the handle down until you hear a click. The triangles on the lid and the blender handle **MUST** be aligned in order for the blender to turn on. **(Fig. 5b)**
- 10 Plug the power cord into the electrical outlet and press the power button (⏻).
IMPORTANT: As a safety feature, the power light (⏻) will flash and the motor will not work if the pitcher and lid are not installed correctly. When the pitcher and lid are installed properly, the power light (⏻) will be solid, indicating that the appliance is ready for use.

Assembly and Use for the Ninja® Blender - cont.

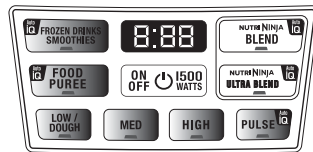

Fig. 6

USE

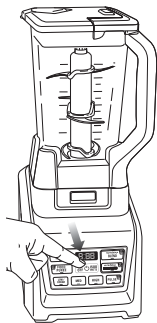

Fig. 7

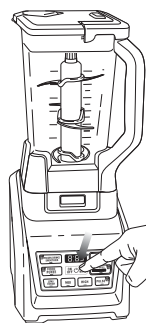

Fig. 8

REMOVAL

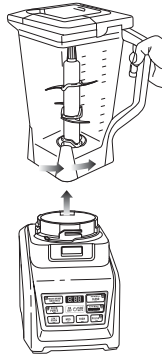

Fig. 9

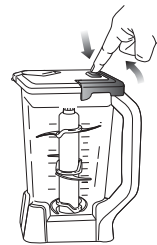

Fig. 10



Fig. 11

NOTE: Nutri Ninja® I Ninja® Blender with Auto-iQ® Technology can sense which jar is on the motor base. The available function lights will illuminate depending on which jar is placed on the motor base. (Fig. 6)

- 11 Review warning and caution statements at the top of page 8 before proceeding to number 12.
- 12 Press the power button to turn on the unit. Select the speed or Auto-iQ program that best suits your needs. The Auto-iQ program will stop the appliance automatically at the end of the program. (Fig. 7)
NOTE: Pulse ingredients for even chopping by holding the Auto-iQ Pulse button until your desired consistency is reached.
NOTE: Max PULSE iteration is 30 Pulses. After 30 Pulses allow 10 minutes to pass before running the PULSE function up to an additional 30 Pulses.
- 13 To pause the appliance, press the selected speed or Auto-iQ program a second time. When the program is paused, the light on the program button will flash until you press it again to resume the rest of the program.
- 14 When you have reached your desired consistency, stop the appliance by pressing the power button (⏻) and wait for the Stacked Blade Assembly to stop turning. (Fig. 8)

- 15 Turn the pitcher anticlockwise to remove and then lift off the base. (Fig. 9)
- ▲ **CAUTION:** Never insert your hands in the pitcher as the blades are sharp. Always use a spatula to dislodge food that has stuck to the sides of the pitcher.
- 16 Open the pour spout cap and use the spout to empty liquid contents.
- 17 For thicker consistencies, first remove the lid by pressing the release button and pulling the lid handle up to a 90 degree angle to lift lid off the pitcher. Then, carefully remove the Stacked Blade Assembly by the top of the shaft. Place Stacked Blade Assembly away from the work area to avoid accidental contact. Finally, empty contents from the pitcher. (Fig. 10)
- 18 Make sure that the unit is unplugged when not in use.
- 19 To release the motor base from the counter or table top, place your hands underneath both sides of the motor base and gently pull the unit up and towards you. (Fig. 11)

Assembly and Use for the Nutri Ninja® Cups

- ▲ **WARNING:** Handle the Pro Extractor Blades™ Assembly with care, as the blades are sharp.
- ▲ **WARNING:** Remove utensils prior to processing. Failure to remove may cause the Nutri Ninja cup to be damaged or to shatter, which may cause personal injury.
- ▲ **WARNING:** Never leave the appliance unattended while in use.
- ▲ **CAUTION:** Do not blend hot liquids, doing so may cause excessive pressure buildup, resulting in risk of the user being burned.
- ▲ **CAUTION:** Remove the Pro Extractor Blades Assembly from the Nutri Ninja cup upon completion of blending. Do not store ingredients before or after blending them in the cup with the blade assembly attached. Some foods may contain active ingredients or release gases that will expand if left in a sealed container, resulting in excessive pressure buildup that can pose a risk of injury. For ingredient storage in the cup, use only Spout Lid to cover.

ASSEMBLY

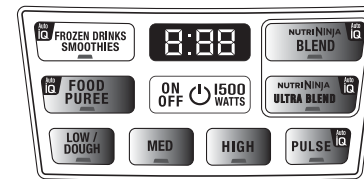

Fig. 1

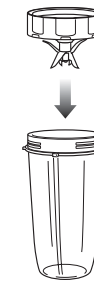

Fig. 2

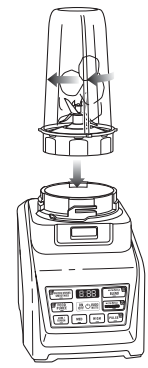

Fig. 3

IMPORTANT: When processing soft dry ingredients such as day-old bread or cheese use quick, short 1 second pulses. Do not overfill to avoid overheating the appliance. Allow the appliance to cool after each use.

NOTE: Nutri Ninja I Ninja® Blender Duo with Auto-iQ® Technology can sense which jar is on the motor base. The available function lights will illuminate depending on which jar is placed on the motor base. (Fig. 1)

- 1 Review warning and caution statements above before proceeding to number 2.
- 2 Place the motor base on a clean, dry, level surface such as a counter or table top. Press down on the motor base to make sure that the suction cups adhere to the counter or table top.

- 3 Add ingredients to the Nutri Ninja cup.
- 4 Place the Pro Extractor Blades Assembly onto the cup and tightly screw it on clockwise until you have a good seal. (Fig. 2)
- 5 Turn the Nutri Ninja cup upside down and place it onto the motor base, aligning the tabs on the cup with the motor base. Rotate the Nutri Ninja cup clockwise until it locks in place, you will hear a click when the lock is engaged. (Fig. 3)

Assembly and Use for the Nutri Ninja® Cups - cont.

USE

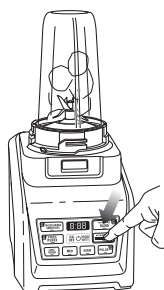

Fig. 4

REMOVAL

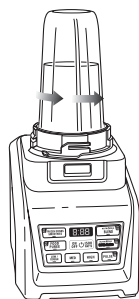

Fig. 5

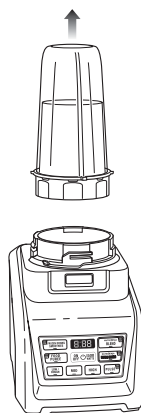

Fig. 6



Fig. 7

6 Review warning and caution statements on page 14 before proceeding.

7 Press the power button on, and select the speed or Auto-iQ program that suits your needs. **(Fig. 4)** The Auto-iQ program will stop the appliance automatically at the end of the program.

8 To pause the appliance, press the selected speed or Auto-iQ program a second time. When the program is paused, the light on the program button will flash until you press it again to resume the rest of the program.

9 Once you have reached your desired consistency, stop the appliance by pressing the power button and wait for the Pro Extractor Blades Assembly to stop turning. Turn the Nutri Ninja® cup anticlockwise and pull straight up to remove. **(Fig. 5, Fig. 6)**

NOTE: Do not overfill! To avoid spilling, do not add ingredients past the "MAX" fill line.

10 Turn the cup upright and remove the Pro Extractor Blades Assembly by twisting the Pro Extractor Blades Assembly anticlockwise. **(Fig. 7)**

11 Do not store blended contents with the Pro Extractor Blades attached.

12 Place the Spout Lid onto the Nutri Ninja cup, twist to seal and enjoy.

13 For storage, use Spout Lid to cover.

14 Be sure to store the Pro Extractor Blades attached to an empty cup when not in use.

NOTE: Spout Lid not intended for use with the XL Multi-serve 1.4 L Ninja Jar.

15 Make sure that the motor base is unplugged when not in use.

16 To release the motor base from the counter or table top, place your hands underneath both sides of the motor base and gently pull the unit up and towards you.



Programs, Speed Settings & Uses for the Pitcher

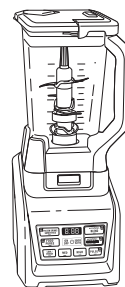

FUNCTION	CONTAINER	BLADE TYPE	SPEED or PROGRAM	TYPE OF FOOD
Frozen Drinks / Ice Crush	Pitcher	Stacked Blade Assembly	Auto-iQ® Frozen Drinks/Smoothies	Ice Frozen Drinks Smoothies
Pureeing	Pitcher	Stacked Blade Assembly	Auto-iQ Food Puree	Smoothies Soups* Milkshakes

Programs, Speed Settings & Uses for the Nutri Ninja® Cup



FUNCTION	CONTAINER	BLADE TYPE	SPEED or PROGRAM	TYPE OF FOOD
Smoothies	Nutri Ninja® Cup XL Multi-serve 1.4 L Ninja Jar Stainless Steel Ninja® Cup	Pro Extractor Blades™ Assembly	Nutri Ninja Auto-iQ Blend	Smoothies Frappes Milkshakes Protein Drinks
Green Smoothies	Nutri Ninja Cup XL Multi-serve 1.4 L Ninja Jar Stainless Steel Ninja Cup	Pro Extractor Blades™ Assembly	Nutri Ninja Auto-iQ Ultra Blend	Frozen Fruits Frozen Vegetables Kale Celery Spinach Seeds Ice
Grating	Nutri Ninja Cup	Pro Extractor Blades™ Assembly	Auto-iQ Pulse Nutri Ninja Auto-iQ Blend High	Grated Cheese Bread Crumbs
Chopping	Nutri Ninja Cup	Pro Extractor Blades™ Assembly	Auto-iQ Pulse Nutri Ninja Auto-iQ Blend High	Salsa Vegetables Nuts

IMPORTANT: Do not run the appliance over 4 minutes at a time to prevent overheating of the appliance.

* When blending sauces and soups, make sure they're cooled to room temperature first - Ninja® containers are not intended for hot blending.

Care & Maintenance

HOW TO CLEAN

- ⚠️ **CAUTION: Make sure that the motor base is unplugged from the power source before inserting or removing any attachment and before cleaning.**
- ⚠️ **CAUTION: DO NOT immerse the motor base into water or any other liquid.**
- 1 Separate/remove all parts from each other.
- 2 **Hand Washing:** Wash the containers, lids, blade assemblies and attachments in warm, soapy water. When washing the blade assemblies, use a dish-washing utensil with a handle to avoid direct hand contact with blades. Handle blade assemblies with care to avoid contact with sharp edges. Rinse and air dry thoroughly.

Dishwasher: The containers, lids, blade assemblies and attachments are all dishwasher safe. The lids and Blade Assemblies are top rack dishwasher safe. Ensure that the Blade Assemblies are removed from the containers before placing in the dishwasher.
- ⚠️ **WARNING: Handle the Blade Assemblies with care when washing, as the blades are sharp. Contact with the blades' edges can result in laceration.**
- 3 Wipe the motor base clean with a damp cloth.

Please call customer service if any servicing needs to be performed on the appliance at 0800 862 0453.

HOW TO STORE

- 1 Store the Nutri Ninja® | Ninja® Blender Duo™ with AUTO-iQ™ Technology upright with the blade assembly inside the corresponding container with the lid secured on top. Do not place anything on top. Store the rest of the attachments in a safe place where they will not be damaged and won't cause harm. Loosely wrap the power cord around the motor base

NOTE: Do not store blended or unblended ingredients in the Nutri Ninja cup with the blade assembly attached.

RESETTING THE MOTOR THERMOSTAT

Store the Nutri Ninja® | Ninja® Blender with Auto-iQ® Technology features a unique safety system which prevents damage to the unit's motor and drive system should you inadvertently overload your appliance. **If the appliance is being overloaded, the motor will stop. Allow the appliance to cool for approximately 15 minutes.** To reset the appliance, follow the resetting procedure below:

- 1 Unplug the appliance from the electrical outlet.
- 2 Remove and empty the container and ensure that no food is jamming the blade assembly.
- 3 Allow the appliance to cool for approximately 15 minutes.
- 4 Re-install the container onto the base and re-plug the appliance into the electrical outlet.
- 5 Proceed to use the appliance as before making sure not to exceed the recommended maximum capacities.

Troubleshooting Guide

PROBLEMS	POSSIBLE REASONS & SOLUTIONS
Motor Doesn't Start or Blade Assembly Doesn't Rotate.	<p>Make sure the container is securely locked into the motor base. Make sure the lid is securely on container in the correct position (align arrows). The appliance is turned "Off". Press the power button (⏻) to turn "On".</p> <p>Check that the plug is securely inserted into the electrical outlet.</p> <p>Check the fuse or circuit breaker.</p> <p>The unit has overloaded. The appliance will stop and the power light will flash. Unplug and wait approximately 15 minutes before using again.</p> <p>The unit has overheated. Unplug and wait approximately 15 minutes before using again. Check to make sure the unit is not overloaded.</p>
Food is Unevenly Chopped.	<p>Either you are chopping too much food at one time, or the pieces are not of even size and processing smaller amounts per batch.</p>
Food is Chopped Too Fine or is Too Watery.	<p>The food has been over processed. Use Auto-iQ® Pulse button for controlled processing.</p>
Food Collects On Lid or On the Sides of the Container.	<p>The mixture is too thick. Add more liquid.</p>
You Cannot Achieve Snow From Solid Ice.	<p>Do not use ice that has been sitting out or has started to melt. Use ice straight from the freezer.</p> <p>Start with a few pulses and then go to a continuous blending cycle.</p>
Motor Base Won't Stick to Counter or Table Top.	<p>Make sure surface and suction feet are wiped clean. Suction feet will only stick to smooth surfaces. Suction feet WILL NOT stick on some surfaces such as, wood, tile and non-polished finishes.</p> <p>DO NOT attempt to use appliance when the motor base is stuck to a surface that is not secure, (cutting board, platter, plates, etc.).</p>
You get an "Err" Message.	<p>Your Ninja® is able to detect which jar is on the base. You may be trying to use a program that is not designed for the jar you have installed. The programs will light up indicating which programs are available for each jar.</p>
You have a blinking red light.	<p>The unit is not installed properly. For your safety the unit will only be able to be turned on when it is properly assembled. Please refer to the assembly pages of this inspiration guide for assistance.</p>



Euro-Pro Europe Limited,
Century Way,
Thorpe Park,
Leeds,
LS15 8ZB, UK

+44 (0)800 862 0453

www.ninjakitchen.eu

Copyright © 2019 SharkNinja Operating LLC.

Auto-iQ, Nutri-Ninja, Ninja, Total Crushing and Pro Extractor Blades
are registered trademarks of SharkNinja Operating LLC.

Printed in China

Illustrations may differ from actual product. We are constantly striving to improve our
products, therefore the specifications contained herein are subject to change without notice.

SN00067b_BL642UK_REV_IB_250220_New address

